



# Sterile Covers

Microscopes - C-Arms - Cameras - Consoles





Sterile covers

# Sterile Covers

---

Microscopes, mobile x-ray units, cameras and other medical devices are nowadays part of the standard equipment in modern operating rooms. Due to continuously increasing hygienic standards, a wide range of protection covers that are easy and safe to apply became a necessity.

**SPIGGLE & THEIS** offers a wide range of top quality sterile covers, featuring glass lenses\* and the patented clip system for the multi-part c-arm covers.

\*microscope covers only



**Sterile Covers**

**Microscopes**

**Description:**

- Standard version = ends with F
- High Quality = ends with H
- Enforced lensering = ends with HX

**Further specifications can be found in the individual product descriptions:**

- Material: Polyethylene
- Lens: Acrylic glass or glass
- Perfect fit on the optics
- EO-sterilized



**Cover versions for microscopes:**

**A**

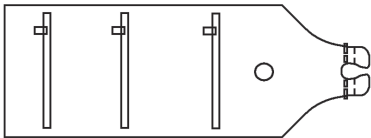

**Without observer tubes  
or other accessories**

**B**

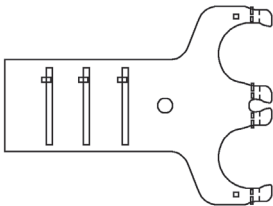

**With extended monocular  
observer tubes**

**C**

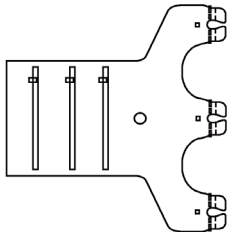

**With binocular  
observer tubes**

**D**

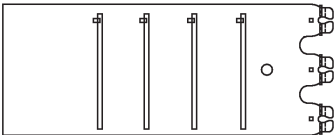

**With binocular  
observer tubes**

**E**

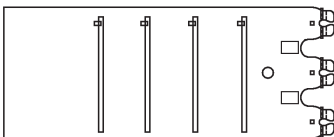

**With binocular observer tubes  
and handgrips**

## Microscopes Covers with acrylic glass lens

### For Zeiss or Möller-Wedel microscopes

| Art.-No.   | Dimensions<br>(cm)     | Lens-Ø<br>(mm) | Shape            | Description        | Packaging<br>(pieces/box) |
|------------|------------------------|----------------|------------------|--------------------|---------------------------|
| 2548020F   | 50 x 155               | 48.0           | A                |                    | 10                        |
| 2548030F   | 125 x 67 x 155         | 48.0           | B                |                    | 10                        |
| 2548040F   | 135 x 80 x 155         | 48.0           | C                |                    | 10                        |
| 2548050F   | 115 x 180              | 48.0           | D                |                    | 10                        |
| 2548070F   | 115 x 260              | 48.0           | D                |                    | 10                        |
| 2548090H   | 115 x 210              | 48.0           | D                |                    | 10                        |
| 2565020H   | 115 x 180              | 65.0           | D                |                    | 10                        |
| 2565030H   | 115 x 260              | 65.0           | D                |                    | 10                        |
| 2565030HG  | 115 x 260              | 65.0           | D                | angled lens        | 10                        |
| 2565030HX  | 115 x 260              | 65.0           | D                | enforced lensering | 10                        |
| 2565035H   | 120 x 260              | 65.0           | E with handgrips |                    | 10                        |
| 2565040H   | 115 x 300              | 65.0           | D                |                    | 10                        |
| 2565040HG  | 115 x 300              | 65.0           | D                | angled lens        | 10                        |
| 2565050H   | 115 x 210              | 65.0           | D                |                    | 10                        |
| 2565060F   | 135 x 80 x 155         | 65.0           | C                |                    | 10                        |
| 2565070F   | 50 x 160               | 65.0           | A                |                    | 10                        |
| 2565080H   | 125 x 67 x 155         | 65.0           | B                |                    | 10                        |
| 2565090H   | 137 x 260              | 65.0           | D                |                    | 5                         |
| 2565100H   | 137 x 380              | 65.0           | D                |                    | 5                         |
| 2565120F   | 50                     | 65.0           | cap-shaped       |                    | 10                        |
| 2565120FXL | 130                    | 65.0           | cap-shaped       |                    | 10                        |
| 2500010    | universal<br>(35 x 14) |                | with handgrips   |                    | 20                        |

### For Leica microscopes

|          |           |      |   |                |    |
|----------|-----------|------|---|----------------|----|
| 2500110H | 115 x 180 | 70.0 | D | angled lens    | 10 |
| 2500120H | 115 x 260 | 70.0 | D | angled lens    | 10 |
| 2500130H | 137 x 265 | 70.0 | D | angled lens    | 5  |
| 2500140H | 115 x 300 | 70.0 | D | angled lens    | 10 |
| 2500140F | 115 x 300 | 70.0 | D |                | 10 |
| 2500150H | 137 x 380 | 70.0 | D |                | 5  |
| 2510110H | 115 x 300 | 87.5 | D | for Leica M680 | 5  |



Sterile Covers

Microscopes

Microscope Covers with Glass Lens

The requirements for the covers are not only simple handling and fast installation. The main requirements are high optical quality and light transmission of the lens. The glass lens is the most important interface between the site and the observer's eye.

Advantages:

- Excellent optical quality
- No image distortion when zooming
- Ideal price-performance ratio



straight glass lens

Covers for Carl Zeiss and Möller-Wedel microscopes

| Art.-No.   | Dimensions (cm) | Lens-Ø (mm) | Packaging (pieces/box) |
|------------|-----------------|-------------|------------------------|
| 2565030GL  | 115 x 260       | 65          | 10                     |
| 2565035GL* | 120 x 260       | 65          | 10                     |
| 2565040GL  | 115 x 300       | 65          | 10                     |
| 2565090GL  | 137 x 260       | 65          | 5                      |
| 2565100GL  | 137 x 380       | 65          | 5                      |

\* with grips



angled glass lens

Cover for Leica microscope

| Art.-No.  | Dimensions (cm) | Lens-Ø (mm) | Packaging (pieces/box) |
|-----------|-----------------|-------------|------------------------|
| 2500130GL | 137 x 265       | 70          | 5                      |

### Quality comparison of drape protective glass

Laboratory experiments have shown that glass lenses reproduce the high quality of the microscope lens, even when zooming in and out, without unwanted distortion of the field of vision.

Laboratory experiments have shown, that the SPIGGLE & THEIS glass lenses meet the highest requirements of the operating room and do not lead to image distortion, even at the edge of the intraoperative field of vision.

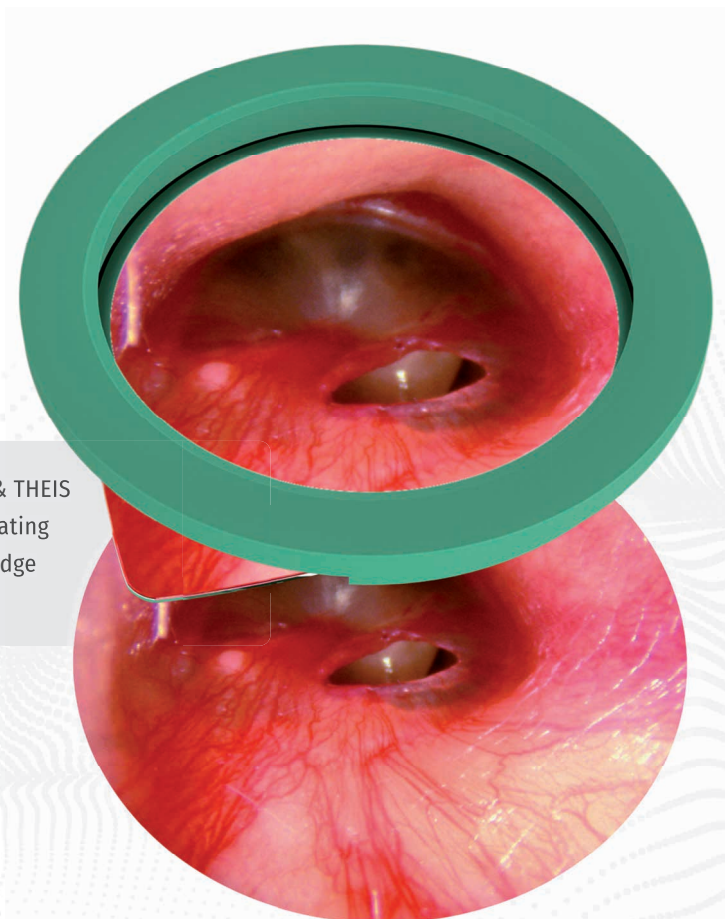

Optic with glass lens

#### Examination with Siemens star:

The Siemens star is a pattern used to test the optical quality of lenses. The focus is on the sharpness of the optical reproduction quality.

## Sterile Covers

### Mobile x-ray units (C-Arm/O-Arm)

#### Sterile covers for mobile x-ray units (C-Arm/O-Arm)

##### Description:

- Material: Polyethylene
- One-piece universal covers as well as two- and three-piece covers for specific systems
- All two- and three-piece covers with special clip system to drape the c-shape
- Patented clip system allows easy movement and adjustment of the c-arm whilst draped (retaining sterility)
- Latex free

A

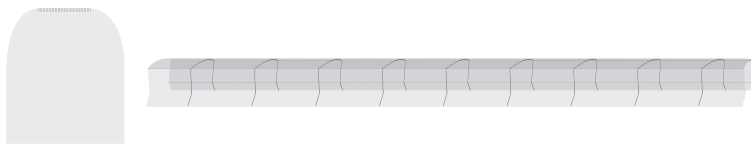

B

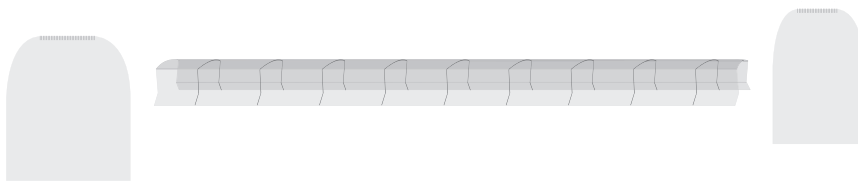

D



E

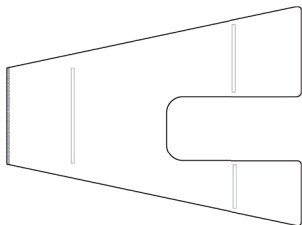

F

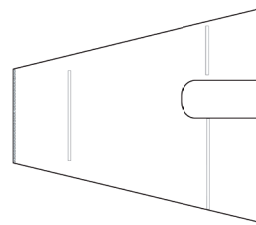

G

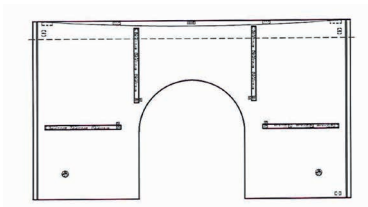

H

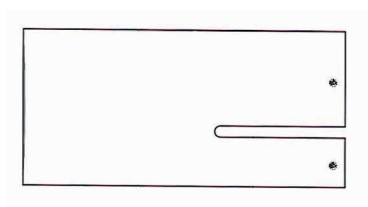

## Sterile Covers

### Mobile x-ray units (C-Arm/O-Arm)

#### Sterile covers for mobile x-ray units (C-Arm/O-Arm)

| Art.-No.         | Dimensions (cm) | Description  | Shape | Feature     | Packaging (pieces/box) |
|------------------|-----------------|--|-------|-------------|------------------------|
| <b>Universal</b> |                 |  |       |             |                        |
| 2900110          | 115 x 240       | universal  | D     | one-piece   | 10                     |
| 2900200          | 150 x 260       | universal, curved shape                            | G     | one-piece   | 10                     |
| 2900300          | 190 x 105       | universal, holding bands                           | D     | one-piece   | 10                     |
| 2900500          | 90 x 210        | universal, 2 strips                                | D     | one-piece   | 10                     |
| <b>Siemens</b>   |                 |  |       |             |                        |
| 2900502          | 210 x 16 x 14*  | for Siremobile 2000                                | A     | two-piece   | 4                      |
| 2900503          | 210 x 16 x 14*  | for Siremobile 2000 / ISO-C / 3D Arcadis Orbic     | B     | three-piece | 4                      |
| <b>Ziehm</b>     |                 |  |       |             |                        |
| 2900602          | 170 x 13 x 9*   | for Ziehm CB7D                                     | A     | two-piece   | 5                      |
| 2900603          | 170 x 13 x 9*   | for Ziehm CB7D                                     | B     | three-piece | 5                      |
| 2900910          | 210 x 16 x 14*  | for C-clip Siremobile 2000 / Ziehm Vista / Libra-C | B     | three-piece | 10                     |
| <b>GE</b>        |                 |  |       |             |                        |
| 2900820          | 105 x 220       | for x-ray unit, Mini / OEC 6600                    | H     | one-piece   | 4                      |
| 2900821          | 137 x 175       | for x-ray unit, Mini / OEC 6800 / Othoscan         | E     | one-piece   | 4                      |
| 2900930          | 210 x 16 x 14   | for GE 9800  | B     | three-piece | 4                      |
| <b>Philips</b>   |                 |  |       |             |                        |
| 2900703          | 190 x 13 x 11*  | for Philips BV/29                                  | B     | three-piece | 4                      |
| 2900712          | 190 x 13 x 11*  | for Philips BV/25 / BV 29 / Libra-6                | A     | two-piece   | 4                      |
| <b>Medtronic</b> |                 |  |       |             |                        |
| 2901000          | 140 x 480       | for Medtronic O-Arm-Surgical 3                     | D     |             | 4                      |

\* Dimension L x W x H of clip/tube system



## Sterile Covers

### Cameras and Cables

#### Sterile Covers for cameras and cables



##### Advantages

- Material: Polyethylene
- One-piece, type-specific covers

**A**

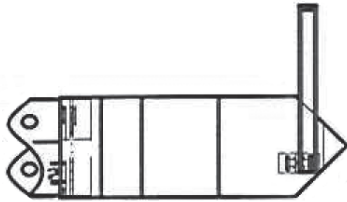

- 13 x 259 cm
- For cameras
- Telescopically folded, with insertion aid
- 50 pieces/box

**2800050**

**B**

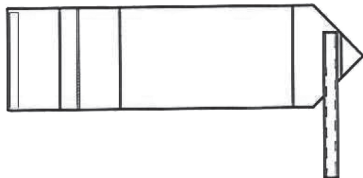

- 15 x 250 cm
- For cameras
- Telescopically folded, with insertion aid
- 20 pieces/box

**2800060**

**C**



- 8 x 150 cm
- For drill cable cover
- 30 pieces/box

**2800070**

**D**

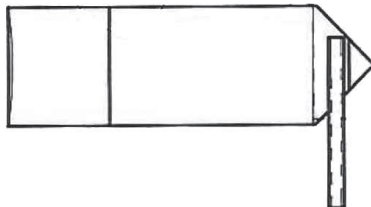

- 15 x 240 cm
- For cameras
- Without insertion aid
- 20 pieces/box

**2800090**

**E**

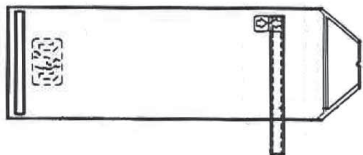

- 17,5 x 240 cm
- For cameras, deluxe version
- 20 pieces/box

**2800100**

**F**

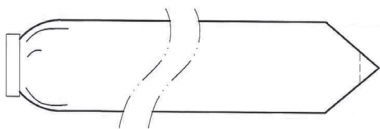

- 16 x 254 cm
- For cameras
- Ring drape
- 15 pieces/box

**2800110**

**G**

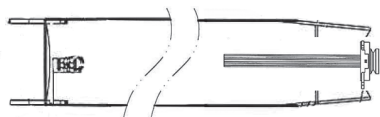

- 15 x 250 cm
- For cameras
- With clutch
- 10 pieces/box

**2800270**

- 18 x 246 cm
- For camera systems
- With coupling
- 40 pieces/box

**DCC 8007**

## Sterile Covers for consoles



## Advantages

- Material: Polyethylene
- One-piece, type-specific covers

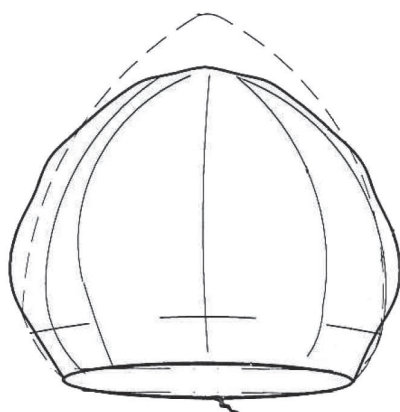

## Sterile covers for consoles

- Round shape
- Double stitched, strong elastic band

| Art.-No. | Dimension (cm) | Packaging (pieces/box) |
|----------|----------------|------------------------|
| 2700001  | 40 x 45        | 20                     |
| 2700011  | 42 x 50        | 20                     |
| 2700021  | 60 x 50        | 20                     |
| 2700031  | 75 x 75        | 15                     |

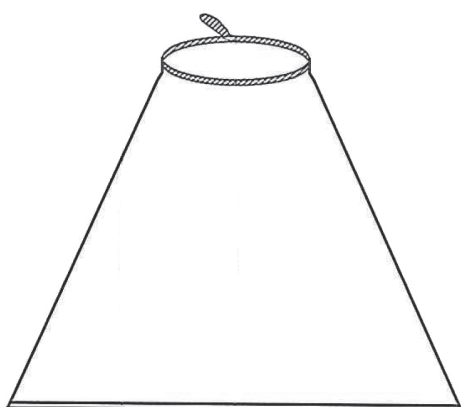

## Sterile covers for console

- Box shape
- Double stitched, strong elastic band

| Art.-No. | Dimension (cm) | Packaging (pieces/box) |
|----------|----------------|------------------------|
| 2700041  | 90 x 75        | 20                     |
| 2700051  | 120 x 110      | 15                     |
| 2700061  | 75 x 75        | 20                     |
| 2700071  | 75 x 90        | 20                     |
| 2700081  | 80 x 100       | 20                     |



